

MC3000 Series

Quick Start Guide

FEATURES

<http://www.zebra.com/mc3000>

See User Guide for more information
This guide is applicable to all MC30XX series products

POST IN WORK AREA

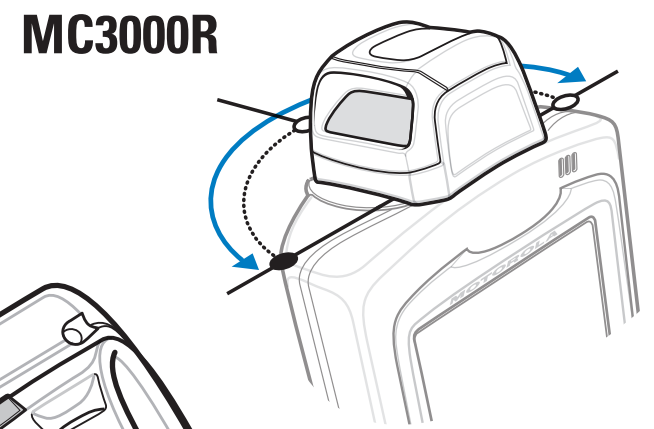
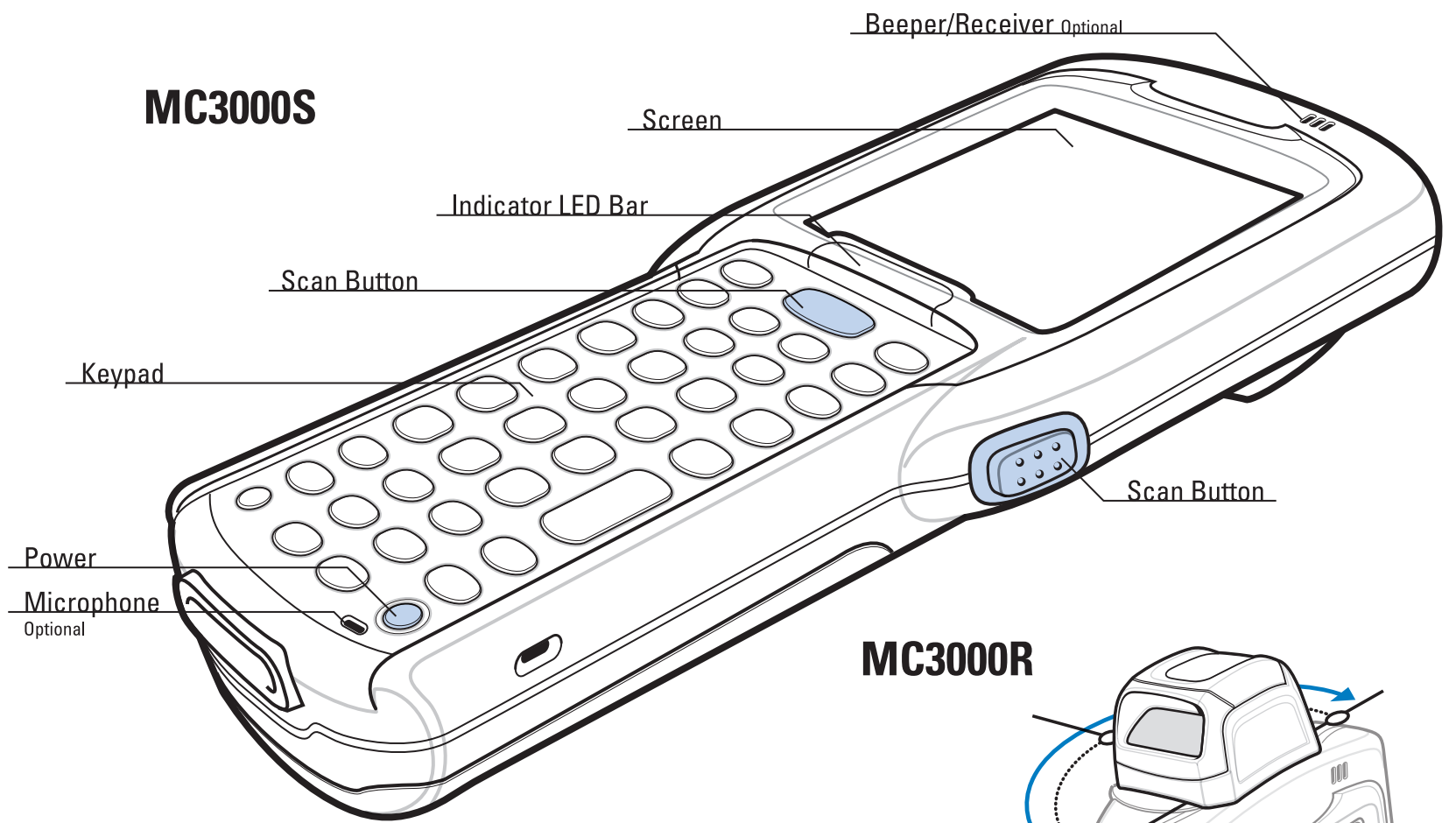
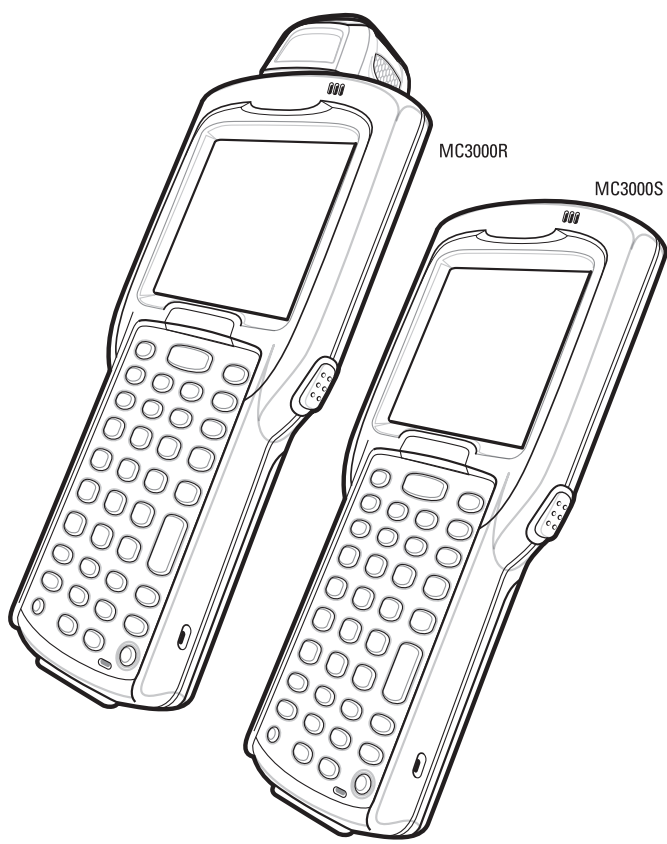

Battery Installation

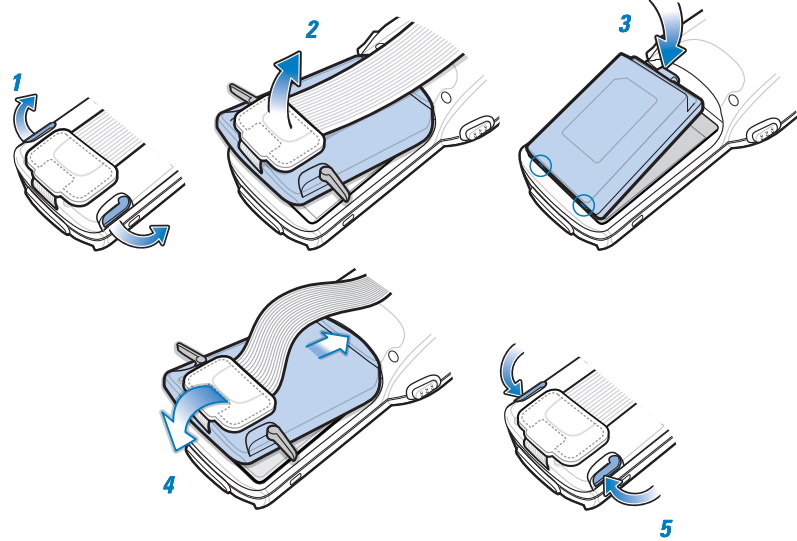

MC3000S Back View

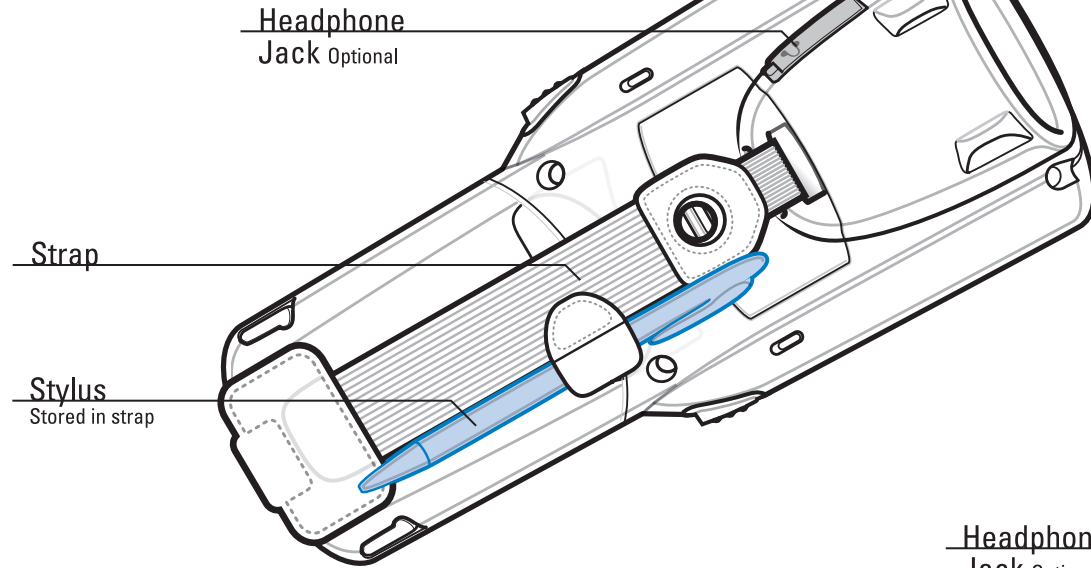

MC3000R Back View

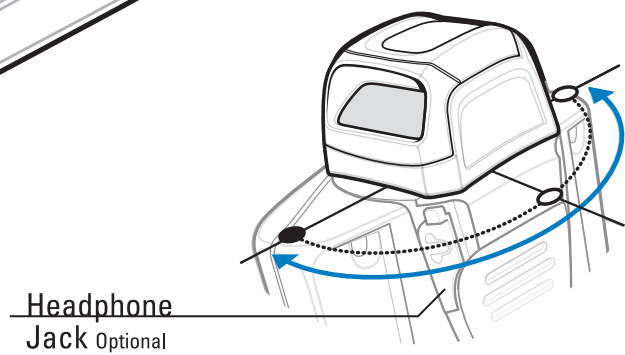

ACCESSORY INSTALLATION

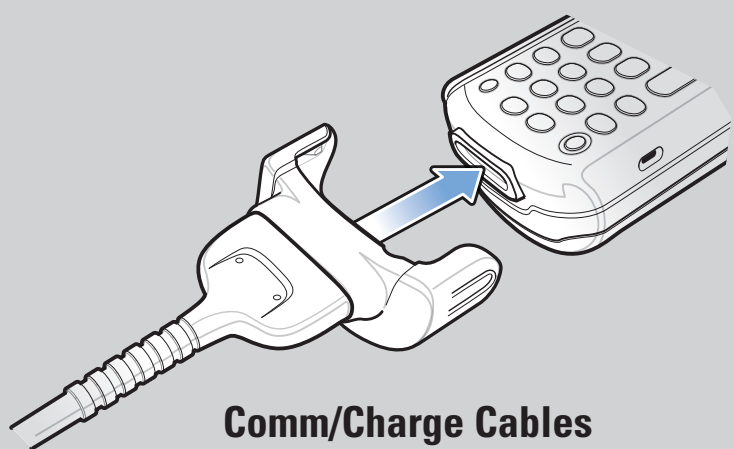

Comm/Charge Cables

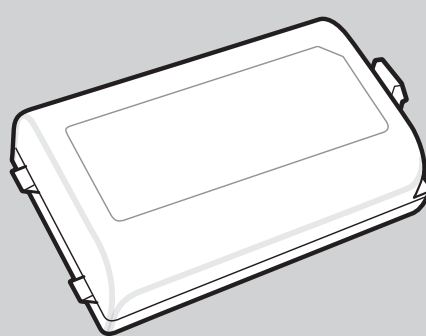

Extended Life Battery

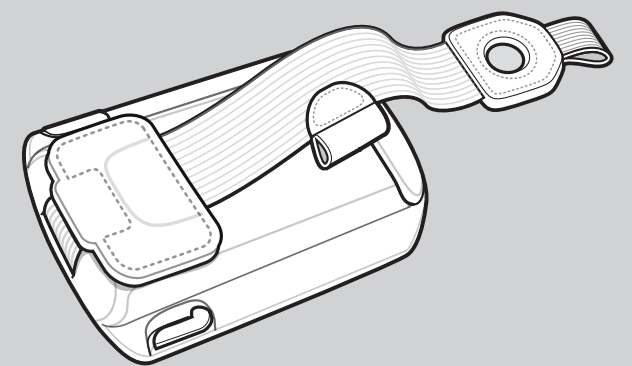

Extended Life Battery Strap/Door Assembly

CHARGING INSTRUCTIONS

⦿ = LED Indicator Location

Slow Flash = Normal Charge

Solid Amber = Full Charge

Fast Flash = Charging Error

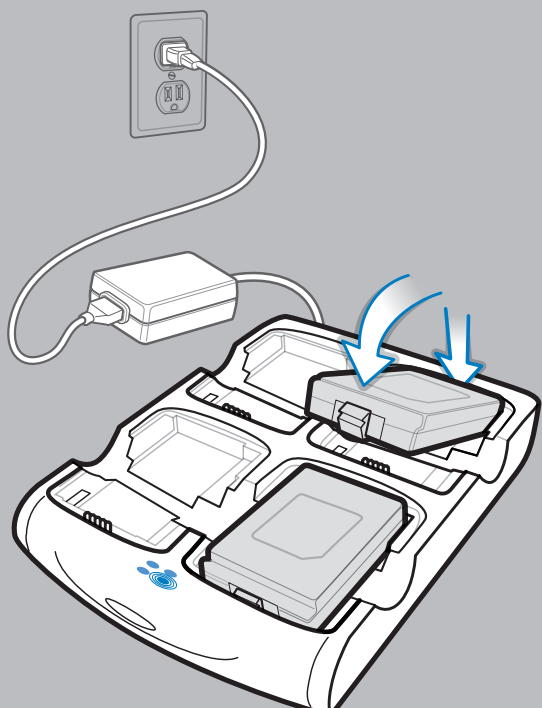

Four Slot Spare Battery Charger

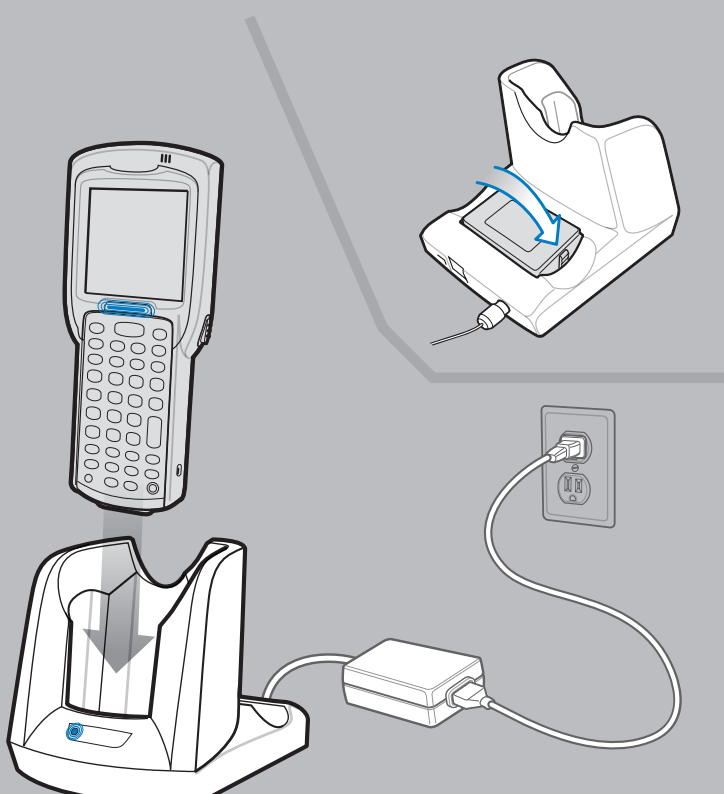

Single Slot Serial/USB Cradle

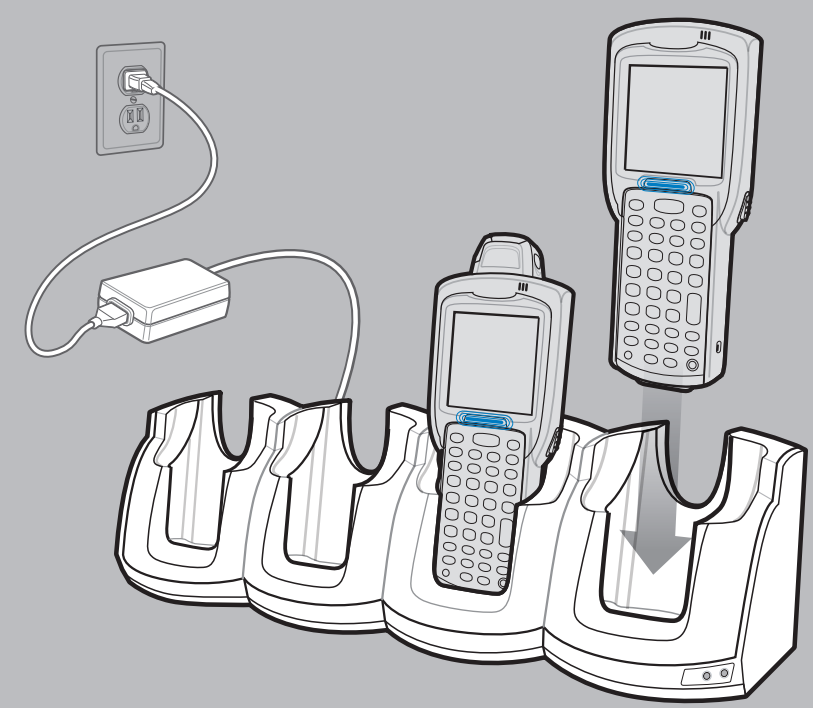

Four Slot Cradles
Charge-Only Cradle and Ethernet Cradle

OPTIMUM IMAGING AND SCANNING POSITIONS

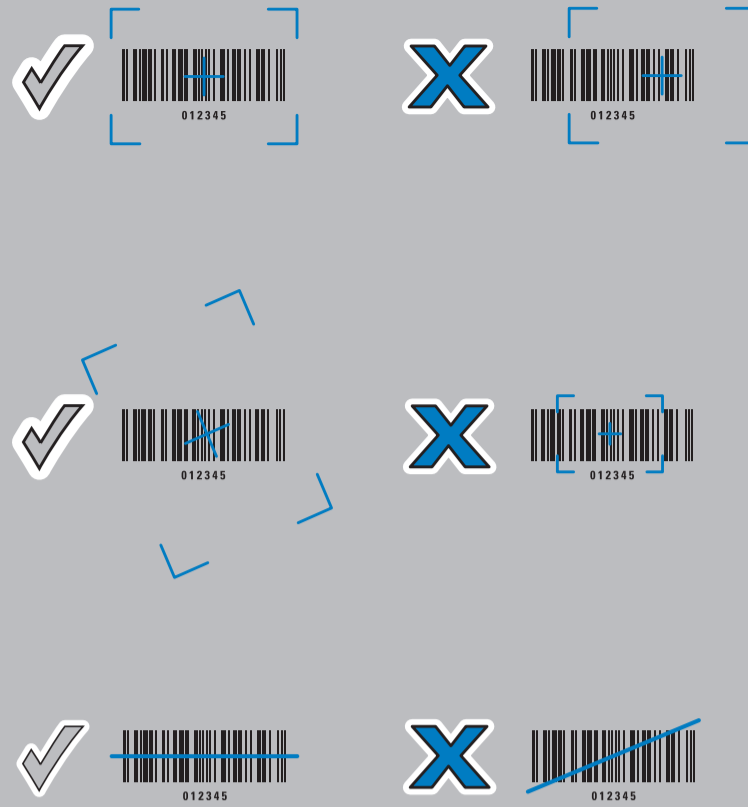
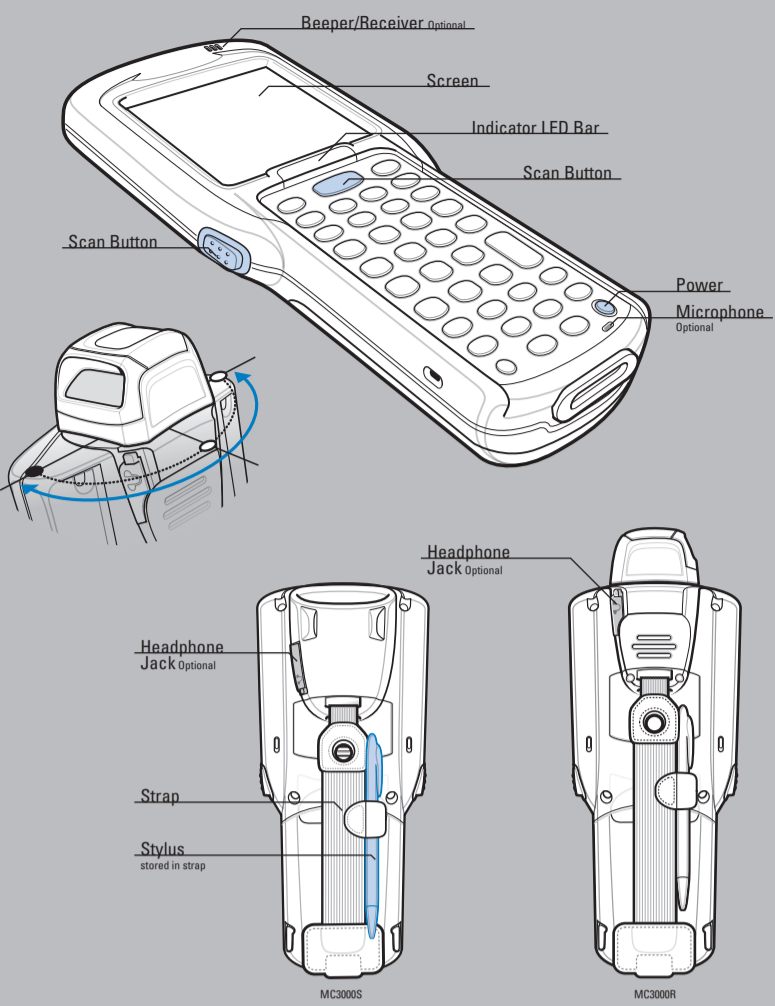

MC3000S Scanning

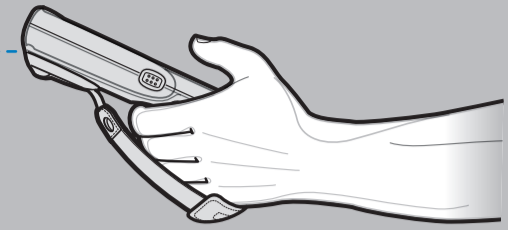

MC3000R Scanning

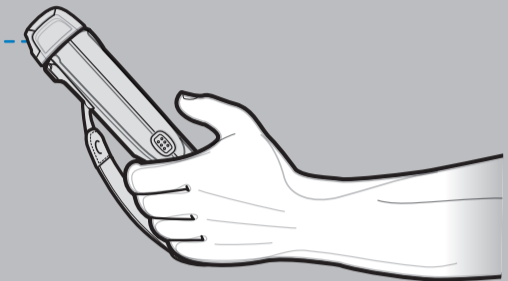

OPTIMUM UPRIGHT BODY POSTURES

MC3000S

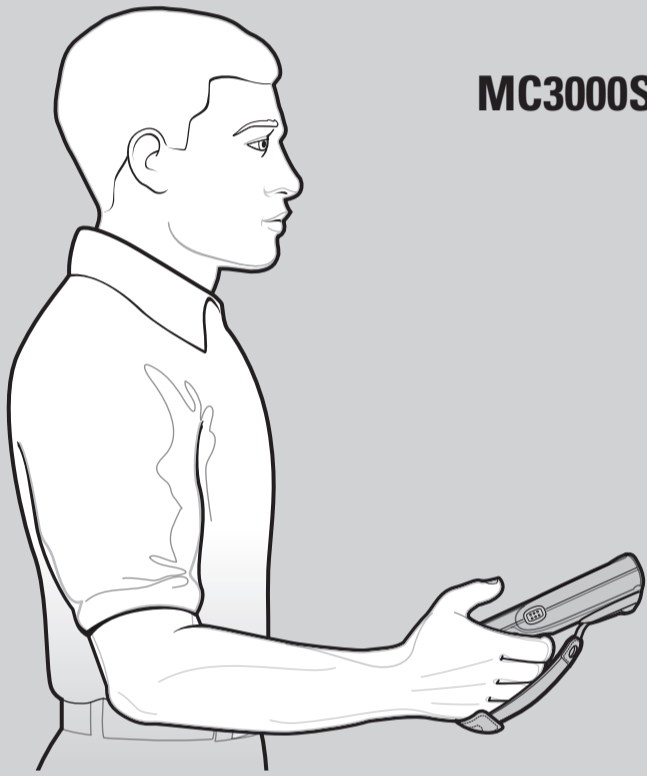

MC3000R

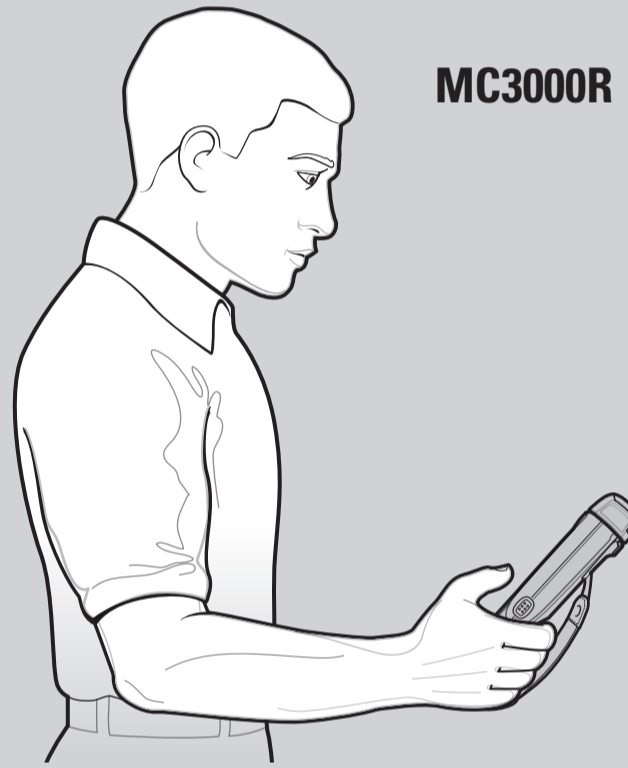

MC3000R



Avoid Extreme Wrist Angles

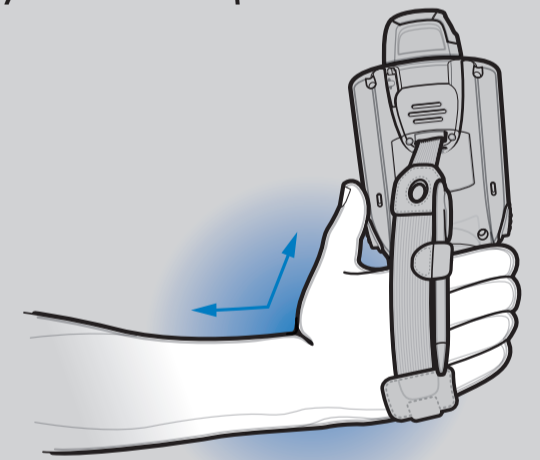
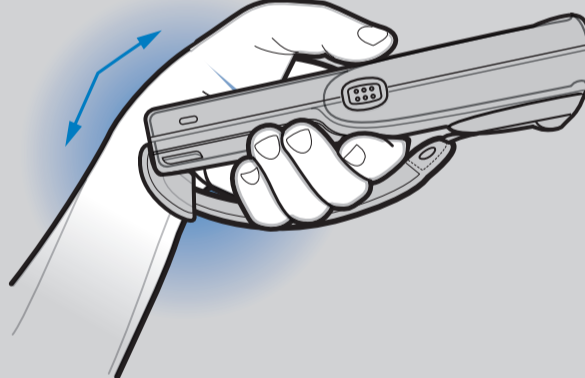

OPTIMUM BODY POSTURE

Optimum Body Posture for Low Scanning

Alternate left and right knees

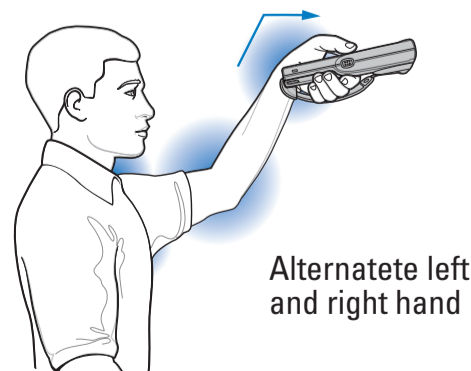

Alternate left and right hand

Optimum Body Posture for High Scanning



Use a ladder

Taking breaks and task rotation recommended

Local Contact: _____

ZEBRA
 Zebra Technologies Corporation
 Lincolnshire, IL U.S.A.
 Zebra and the Zebra head graphic are registered trademarks of ZIH Corp. The Symbol logo is a registered trademark of Symbol Technologies, Inc., a Zebra Technologies company.
 © 2015 Symbol Technologies, Inc.
 72-68902-04 Rev A March 2015