

MC3100 Series

Quick Start Guide

FEATURES

<http://www.zebra.com/mc3100>

See User Guide for more information
This guide is applicable to all MC31XX-S/R series products

POST IN WORK AREA

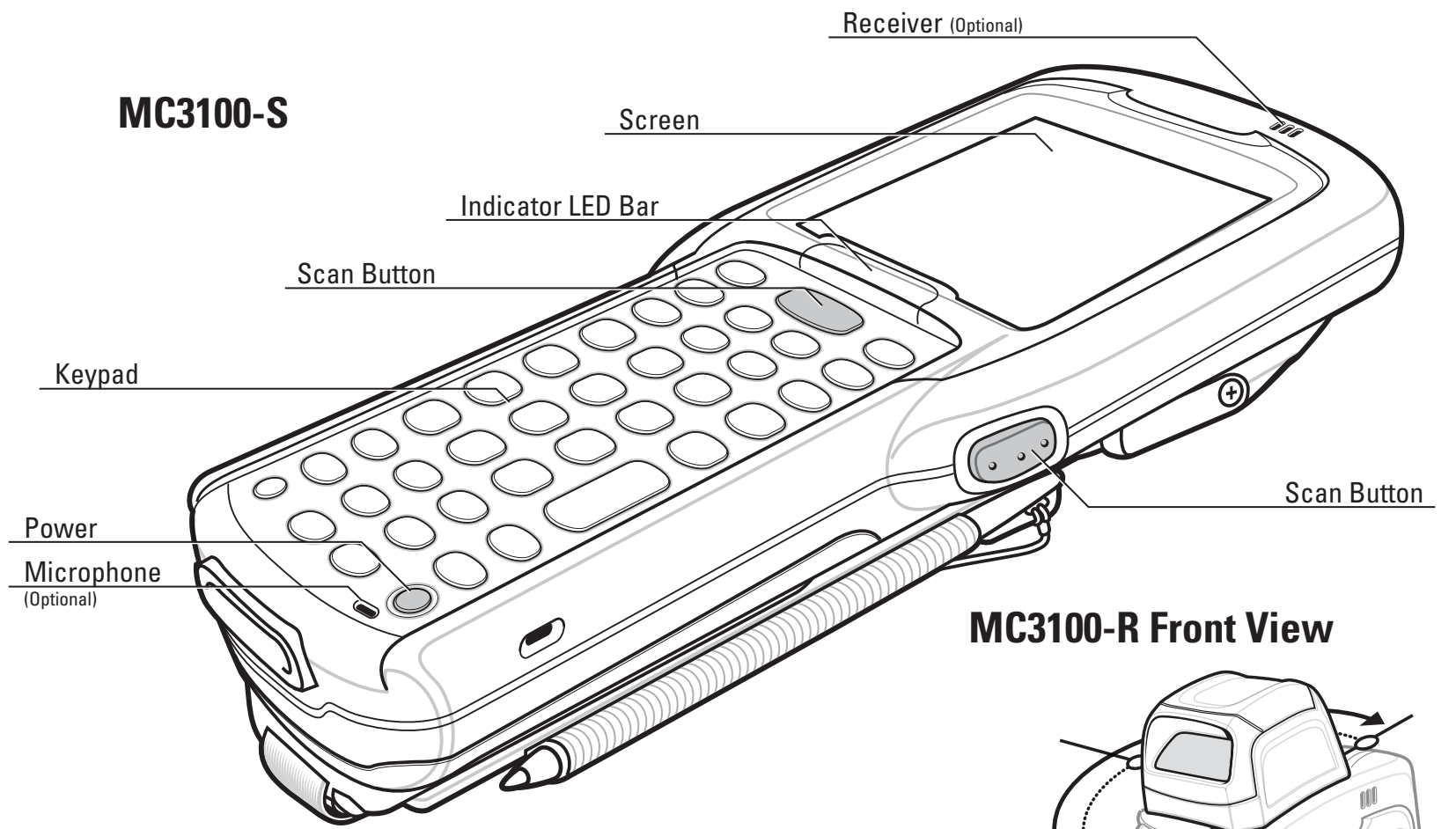
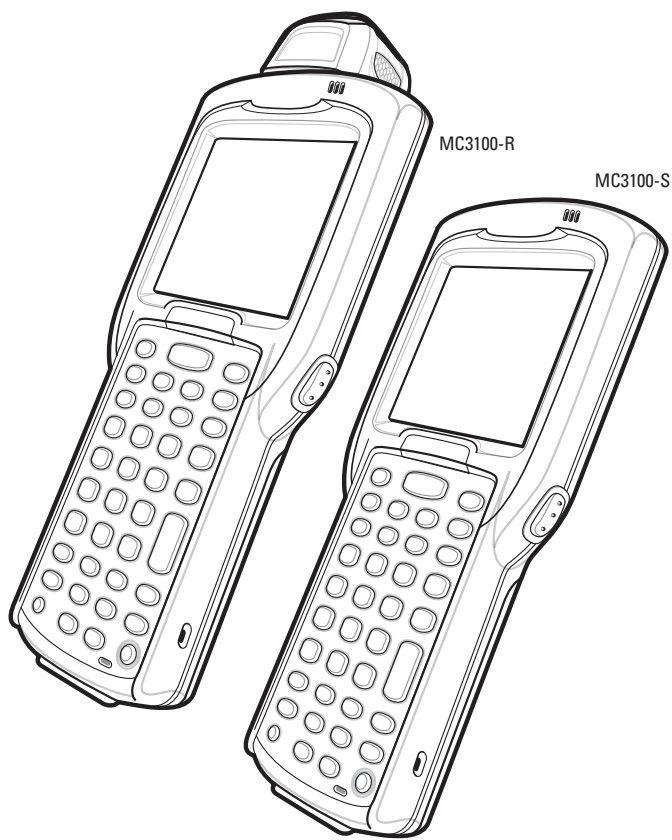

MC3100-R Front View

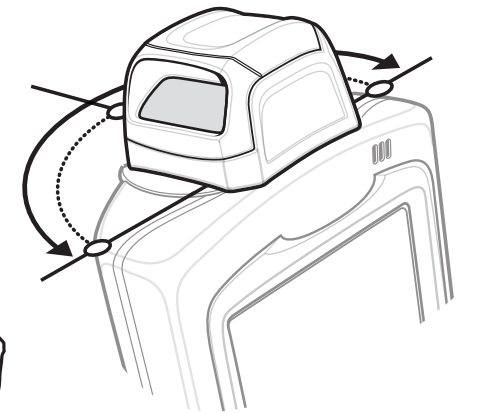

MC3100-R Back View

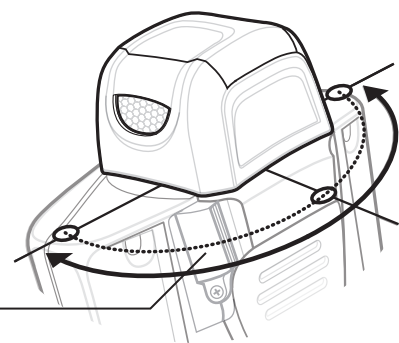

MC3100-S Back View

MC3100-R Back View

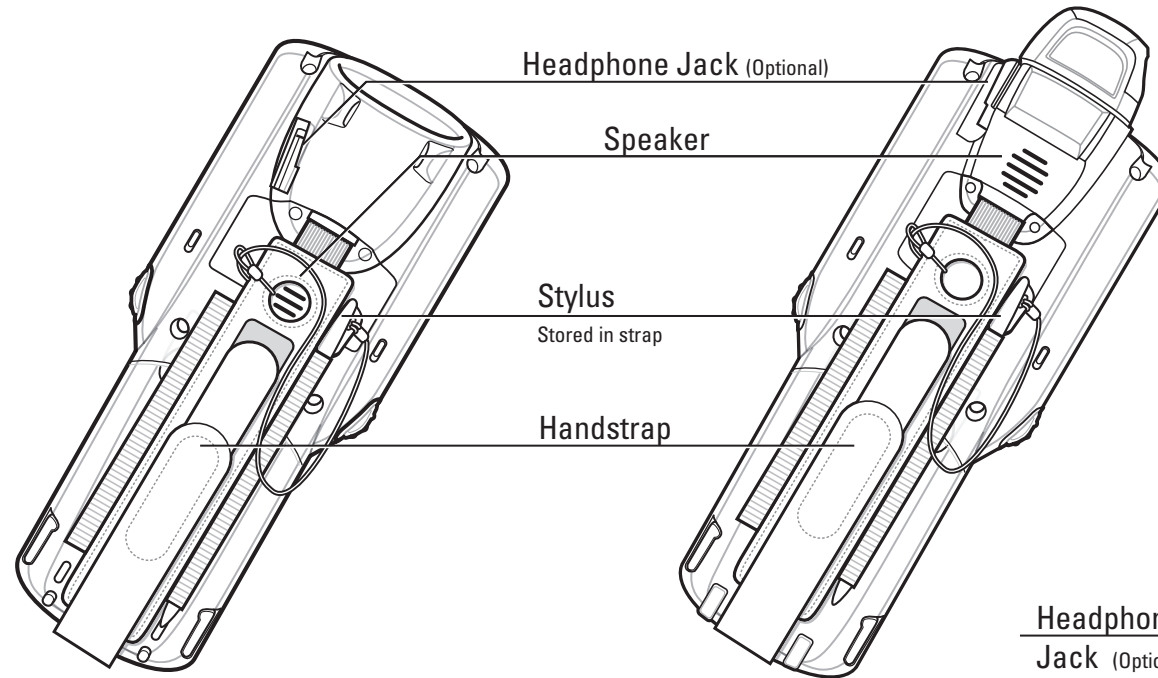

Cable Installation

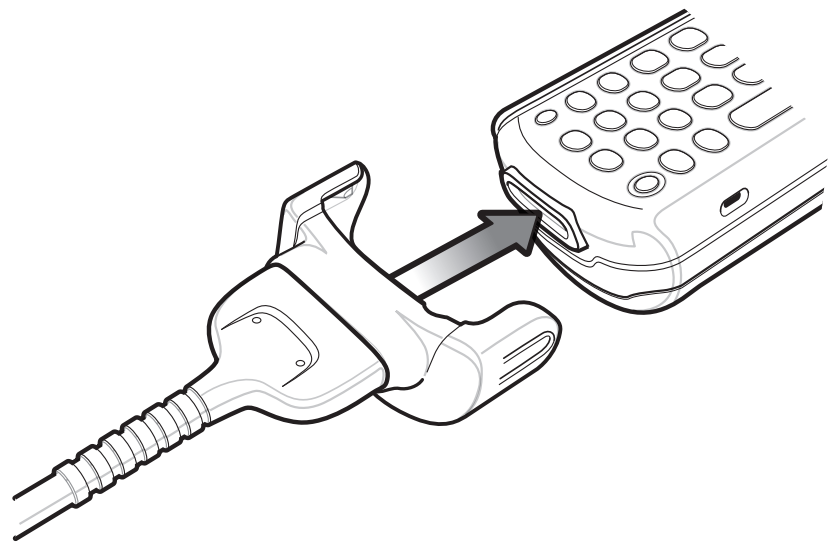

Comm/Charge Cables

BATTERY REMOVAL/INSTALLATION

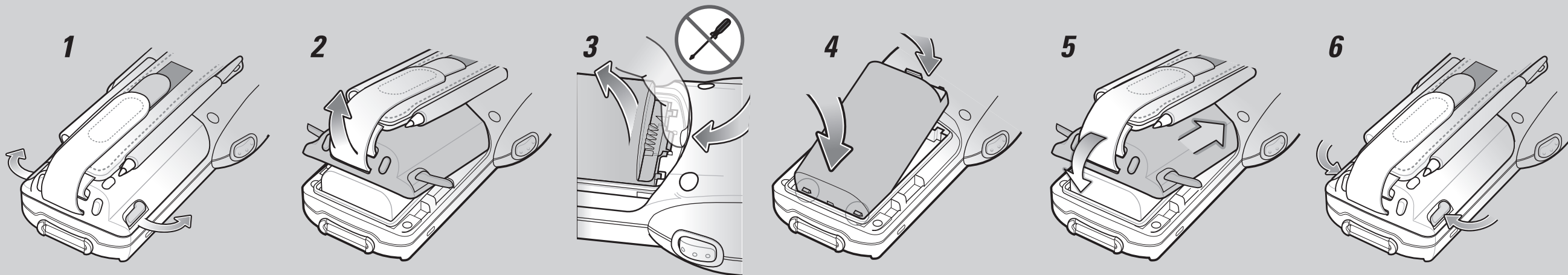

CHARGING INSTRUCTIONS

LED Indicators: Slow Flash = Normal Charge | Solid Amber = Full Charge | Fast Flash = Charging Error

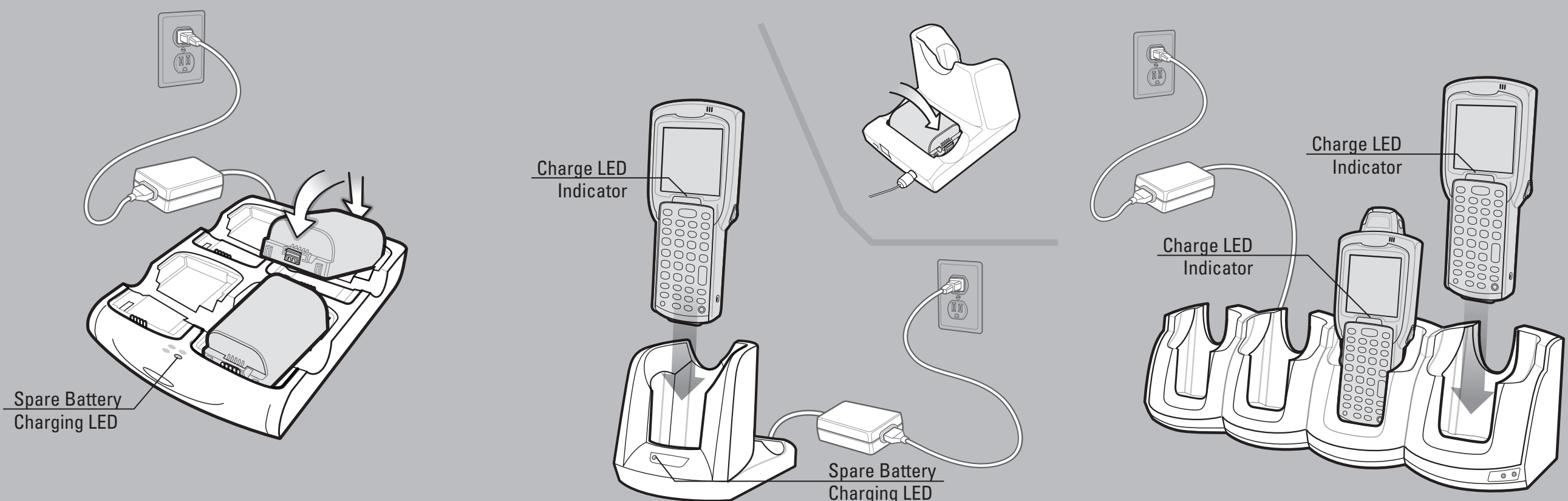

Four Slot Spare Battery Charger

Single Slot Serial/USB Cradle

Four Slot Cradles

Charge-Only Cradle and Ethernet Cradle

HEADSET CONNECTION

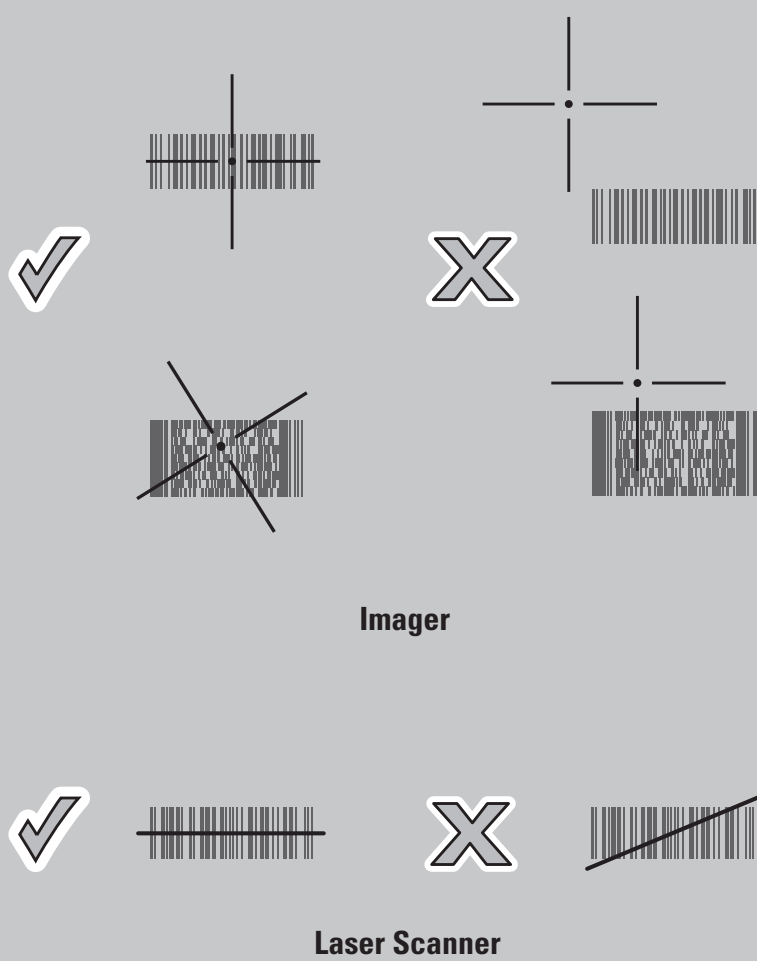
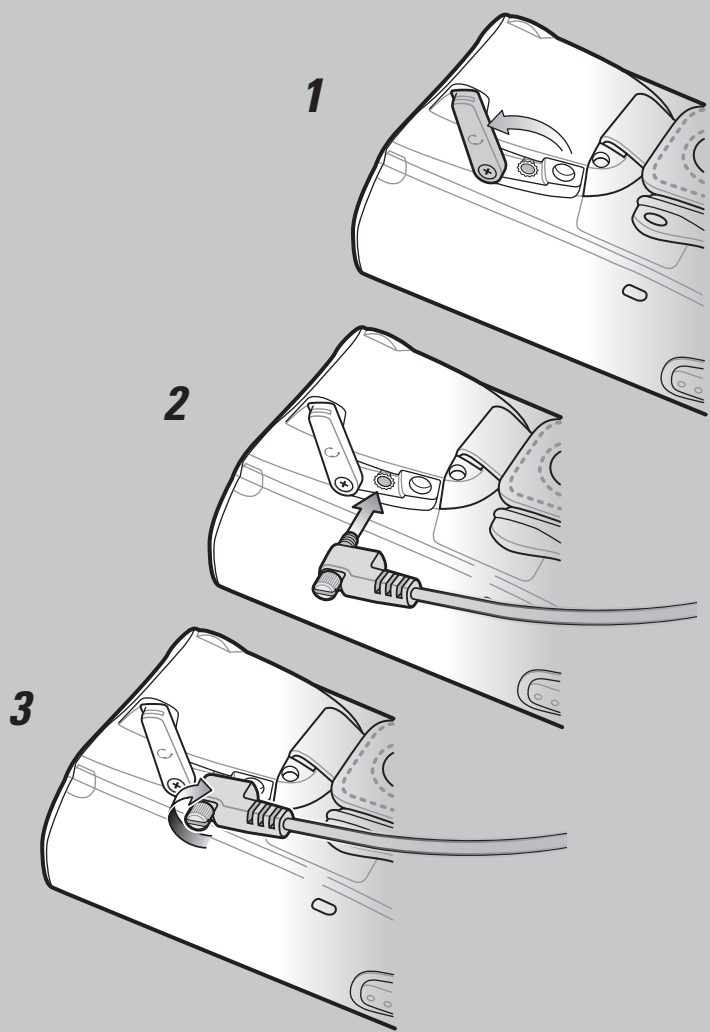

MC3100-S Scanning

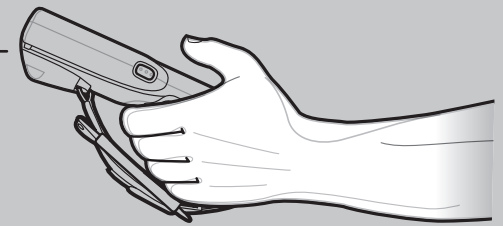

MC3100-R Scanning

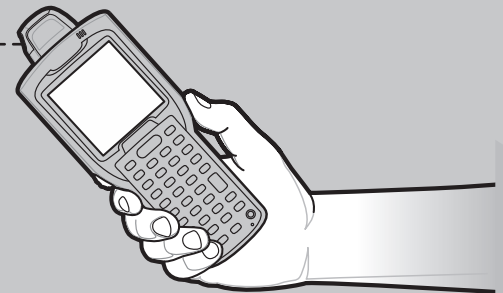
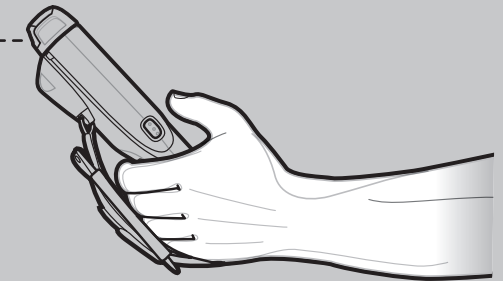

OPTIMUM UPRIGHT BODY POSTURES

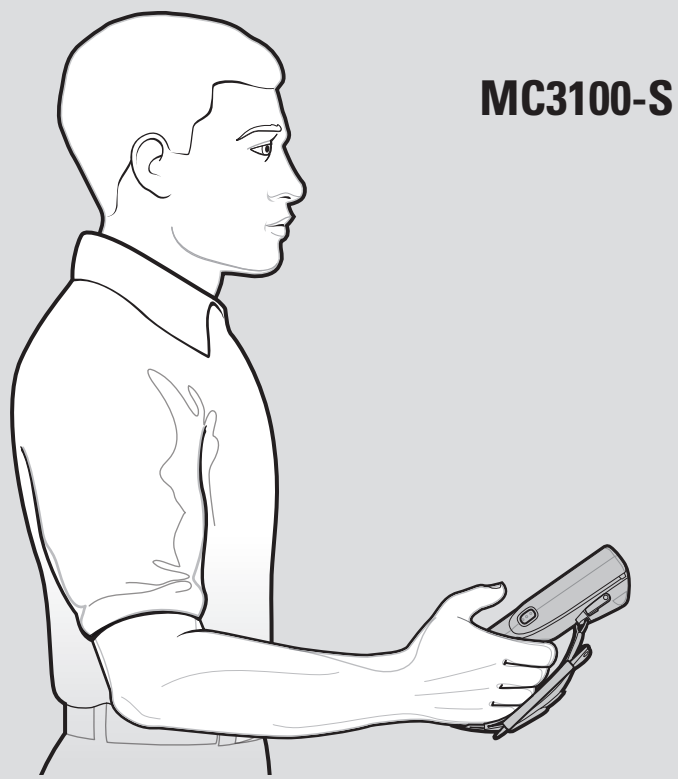

MC3100-S



MC3100-R



MC3100-R

Avoid Extreme Wrist Angles

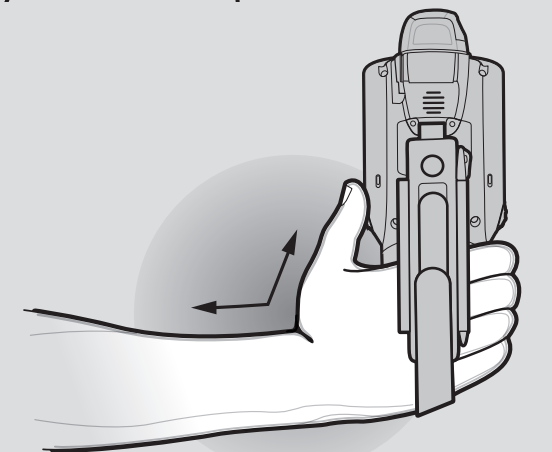
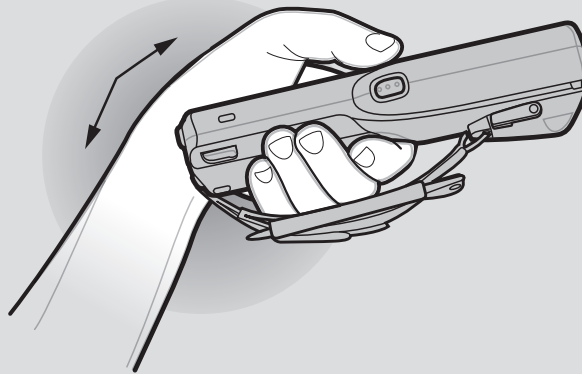

OPTIMUM BODY POSTURE

Optimum Body Posture for Low Scanning



Alternate left and right knees
Alternate left and right hands



Alternate left and right hand

Optimum Body Posture for High Scanning



Use a ladder

Taking breaks and task rotation recommended

Local Contact: _____



Zebra Technologies Corporation
Lincolnshire, IL USA
Zebra and the Zebra head graphic are registered trademarks of the ZIH Corp. The Symbol logo is a registered trademark of Symbol Technologies, Inc., a Zebra Technologies company.
© 2014 Symbol Technologies, Inc.



72-124259-04 Rev. A December 2014



<http://www.zebra.com/mc3100>
Zebra Technologies Corporation Lincolnshire IL USA

POST IN WORK AREA