

TC51/TC56

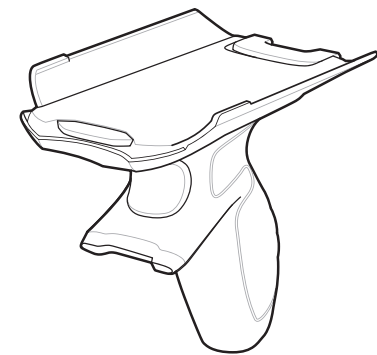

Trigger Handle

Installation Guide



Features

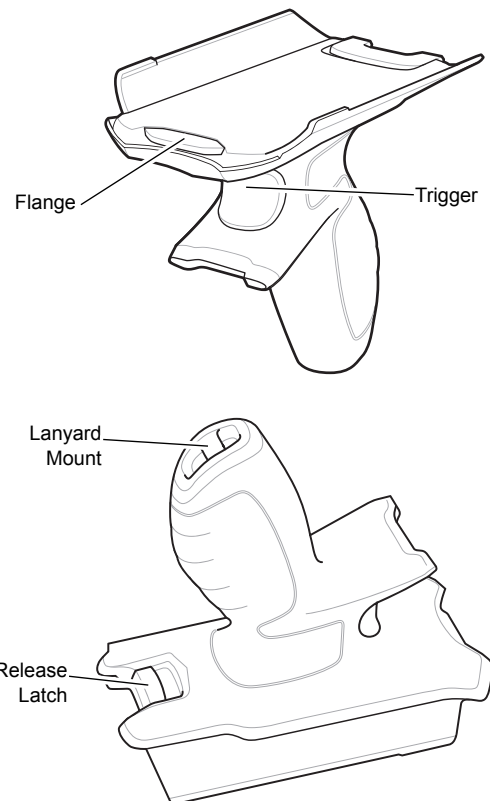

Rugged Boot Installation

NOTE: If hand strap is installed, remove it prior to installation.

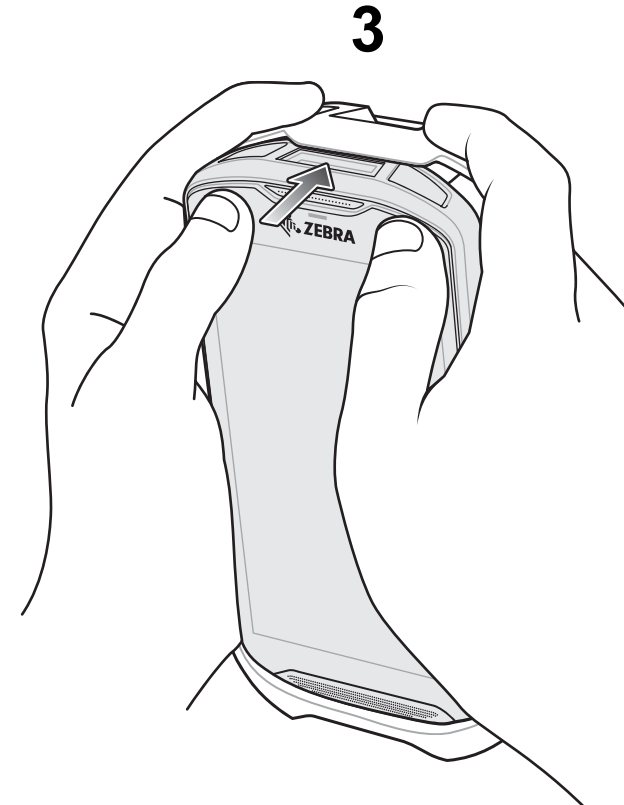
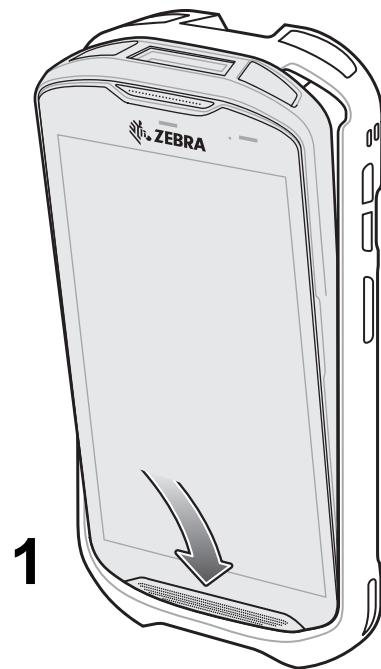

Zebra reserves the right to make changes to any product to improve reliability, function, or design. Zebra does not assume any product liability arising out of, or in connection with, the application or use of any product, circuit, or application described herein. No license is granted, either expressly or by implication, estoppel, or otherwise under any patent right or patent, covering or relating to any combination, system, apparatus, machine, material, method, or process in which the products might be used. An implied license exists only for equipment, circuits, and subsystems contained in Zebra products.



Zebra Technologies Corporation
3 Overlook Point
Lincolnshire, IL, U.S.A.

Zebra and the stylized Zebra head are trademarks of ZIH Corp., registered in many jurisdictions worldwide. All other trademarks are the property of their respective owners.

© 2016 Symbol Technologies LLC, a subsidiary of Zebra Technologies Corporation. All rights reserved.



MN-002906-01 Revision A — September 2016



Device Installation

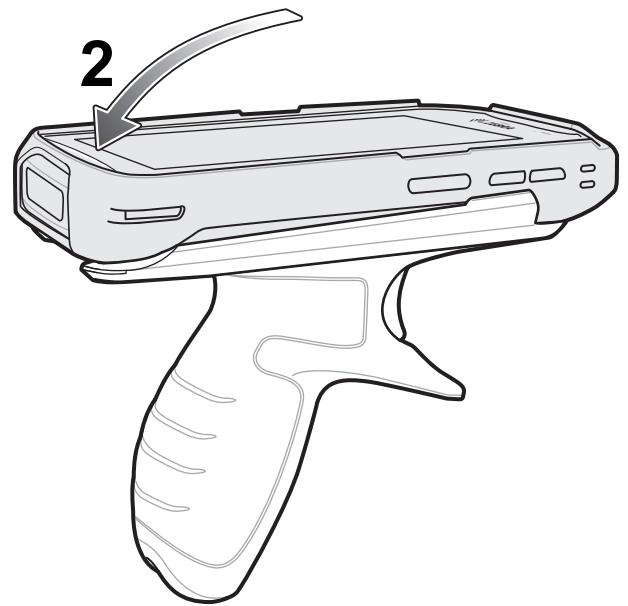
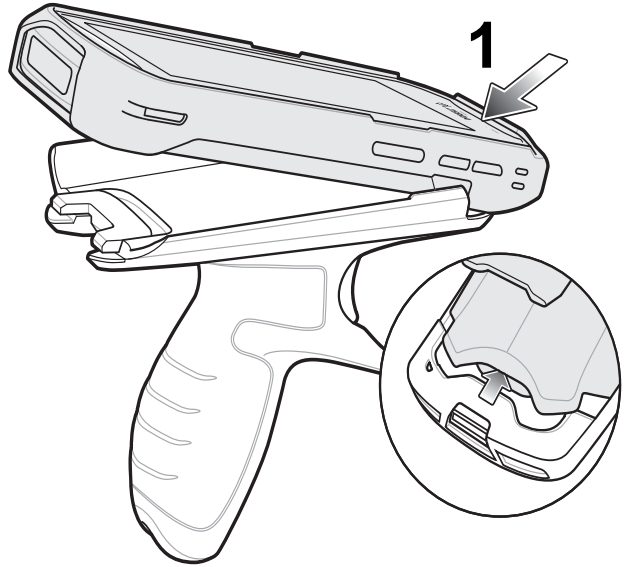

Charging

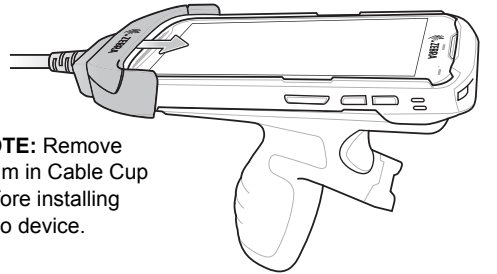

NOTE: Remove Shim in Cable Cup before installing onto device.

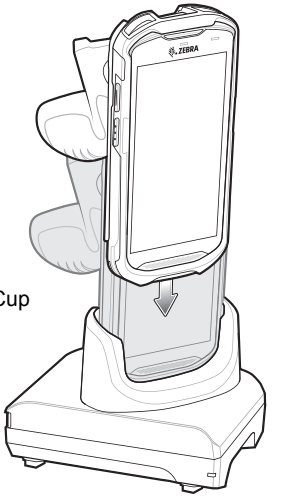

NOTE: Remove Shim in Cradle Cup before installing onto device.

Optional Lanyard Installation

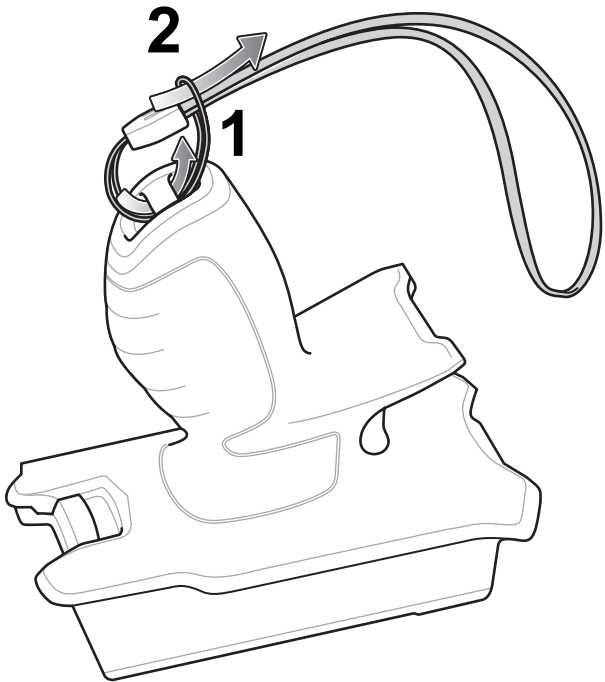

Removal

