

WT4090
Mounting Bracket
Installation Instructions

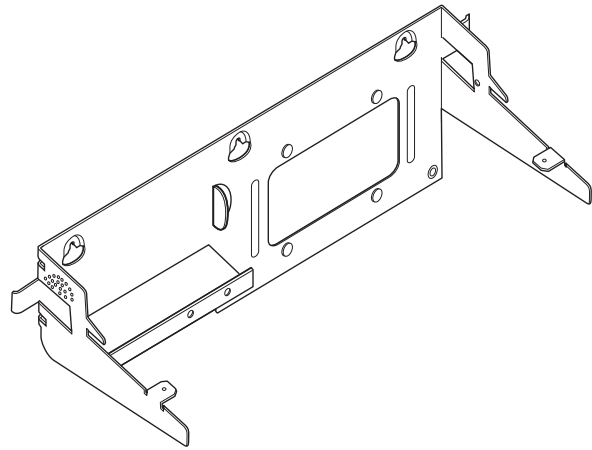

Wall Mounting

Use the wall mounting bracket as a template. Place the bracket onto the wall, level and mark the five screw hole locations.

1. Install top three screws into the wall.
2. Align the top three mounting holes with the screws.
3. Place mounting bracket on screws.
4. Secure the mounting bracket to the wall by tightening the three screws.
5. Install and secure two screws at the bottom of the bracket.

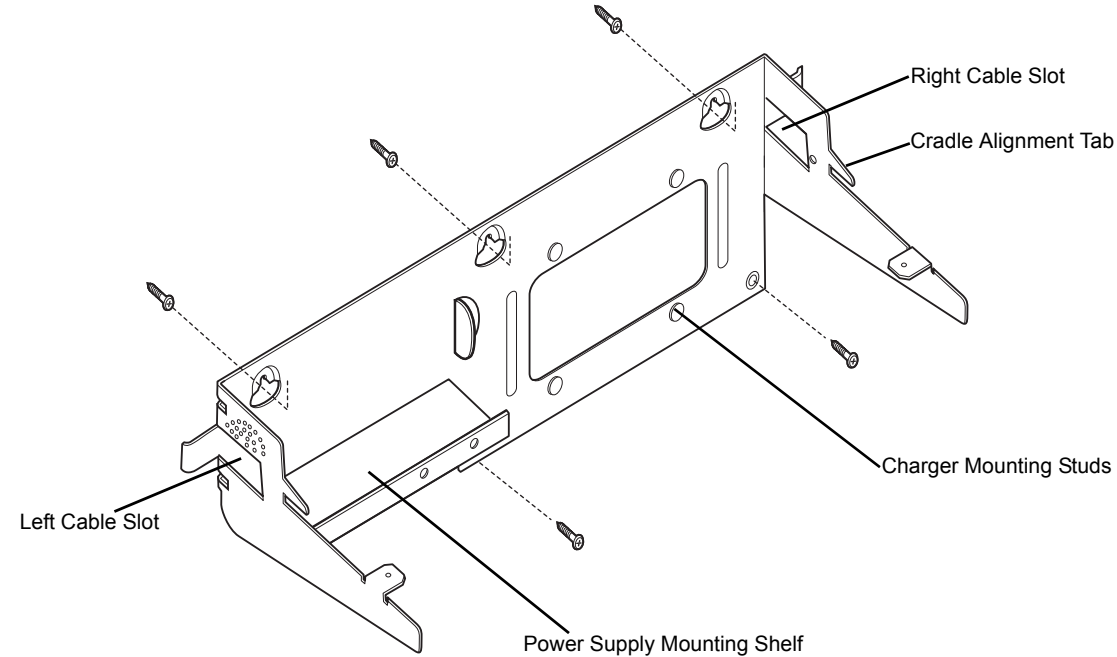

Power Supply Installation

Place power supply onto mounting shelf with the DC output connector and fan facing out and with the fan on top.

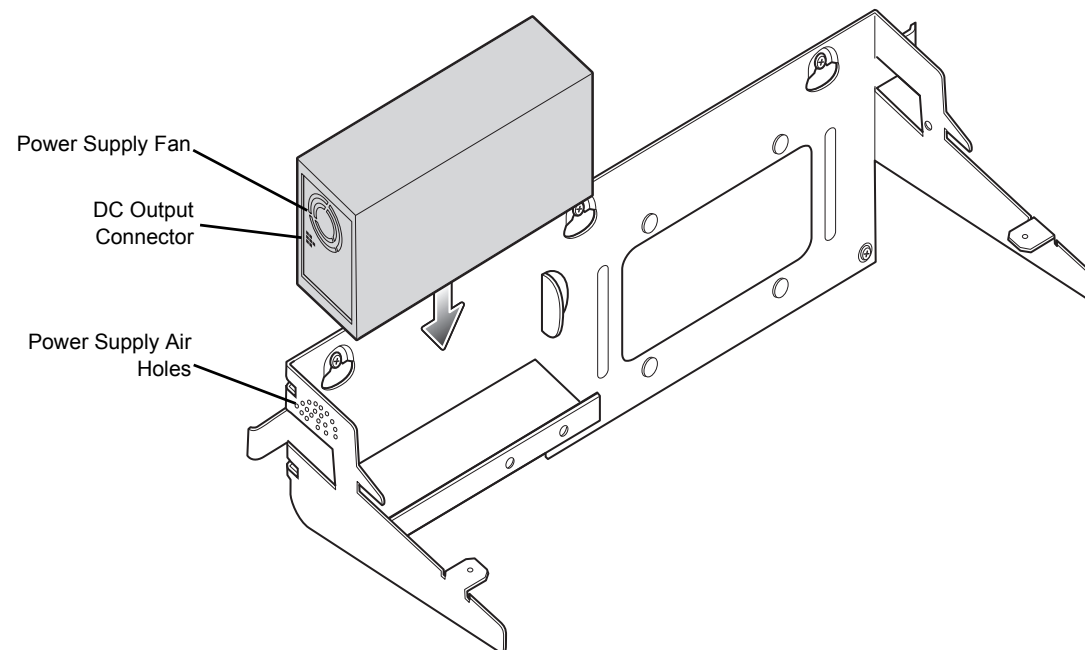

Four Slot Ethernet Cradle Installation

1. Align the two slots in the back of the cradle with the two cradle alignment tabs on the bracket.

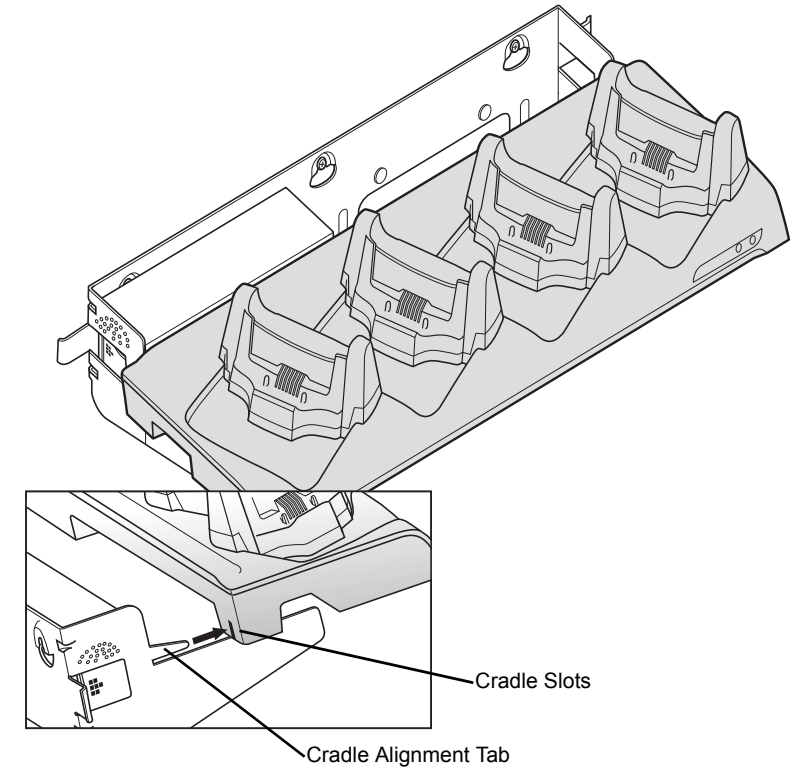

2. Secure the cradle to the mounting bracket with two M4.0 screws supplied with the bracket.

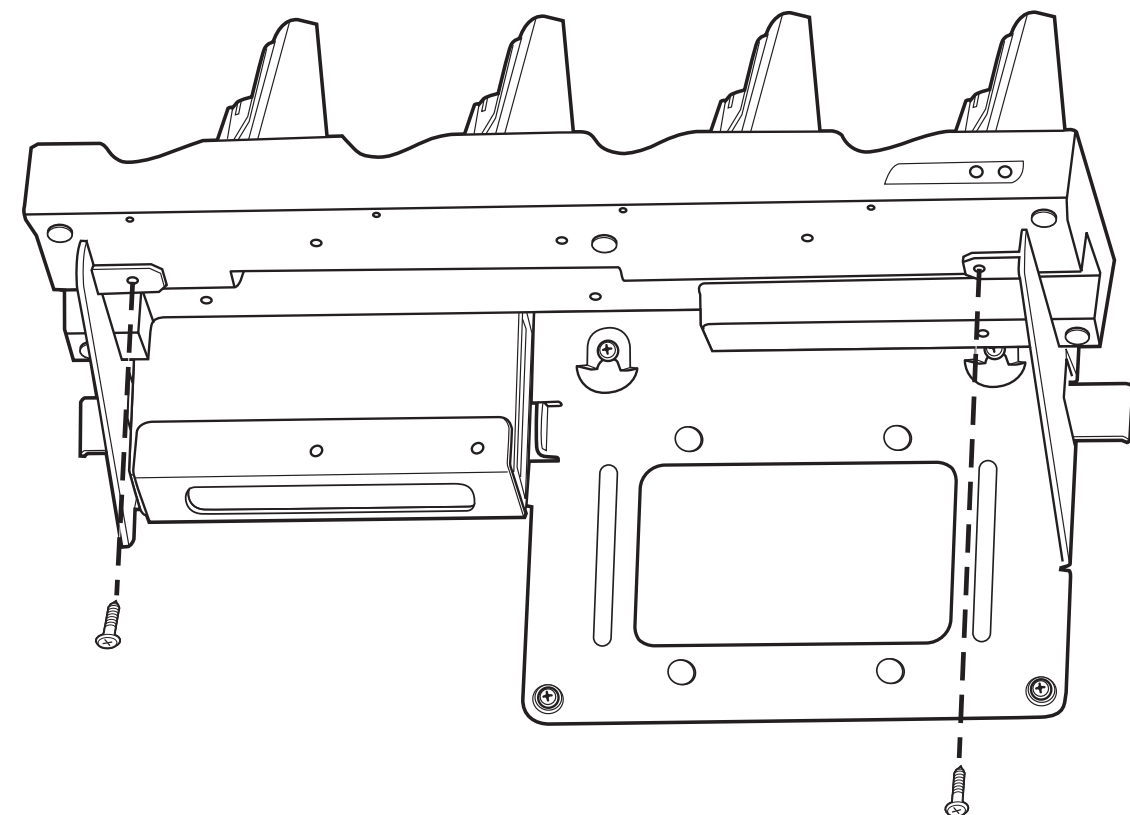

Zebra reserves the right to make changes to any product to improve reliability, function, or design.

Zebra does not assume any product liability arising out of, or in connection with, the application or use of any product, circuit, or application described herein.

No license is granted, either expressly or by implication, estoppel, or otherwise under any patent right or patent, covering or relating to any combination, system, apparatus, machine, material, method, or process in which Zebra products might be used. An implied license exists only for equipment, circuits, and subsystems contained in Zebra products.

Zebra and the Zebra head graphic are registered trademarks of ZIH Corp. The Symbol logo is a registered trademark of Symbol Technologies, Inc., a Zebra Technologies company.

Warranty

For the complete Zebra hardware product warranty statement, go to:

<http://www.zebra.com/warranty>



Zebra Technologies Corporation
Lincolnshire, IL U.S.A.
<http://www.zebra.com>

Zebra and the Zebra head graphic are registered trademarks of ZIH Corp. The Symbol logo is a registered trademark of Symbol Technologies, Inc., a Zebra Technologies company.

© 2015 Symbol Technologies, Inc.



Four Slot Battery Charger Installation

The Four Slot Spare Battery Charger has four mounting slots on the back. Around the slots are guides that assist in proper alignment of the charger onto the mounting bracket. Gravity holds the charger in place.

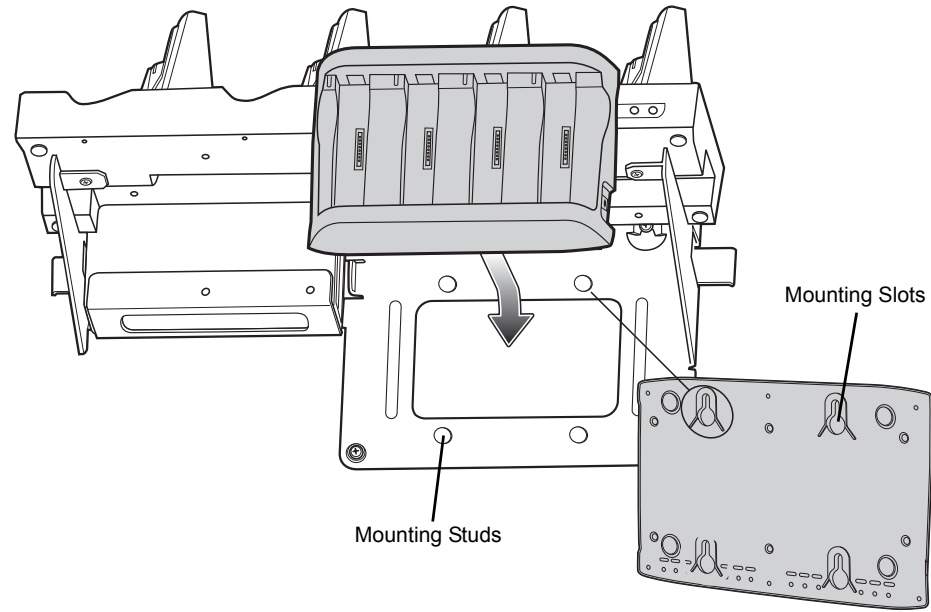

Position the charger over the mounting studs and slide the charger into place. Ensure that the charger is seated properly.

Wiring

The AC line cord provides AC power to the power supply. The mounting bracket power cable provides power from the power supply to the Four Slot Ethernet cradle and the Four Slot Spare Battery Charger.

Ensure that the AC line cord is long enough to reach from the AC power source to the power supply.

1. Route the AC line cord through the right cable slot of the bracket.
2. Plug the AC line cord into the power supply AC input connector.
3. Route the power supply connector of the power cable through the cradle channel and out the left side of the cradle.
4. Plug the power cable connector into the DC output connector on the power supply.
5. Plug the cradle power plug into the Four Slot Ethernet cradle input power connector.
6. Plug the charger power plug onto the Four Slot Spare battery Charger input power connector.
7. Route the cables as shown.
8. Use two tie-wraps to secure the power cable Y connection to the power supply mounting shelf.

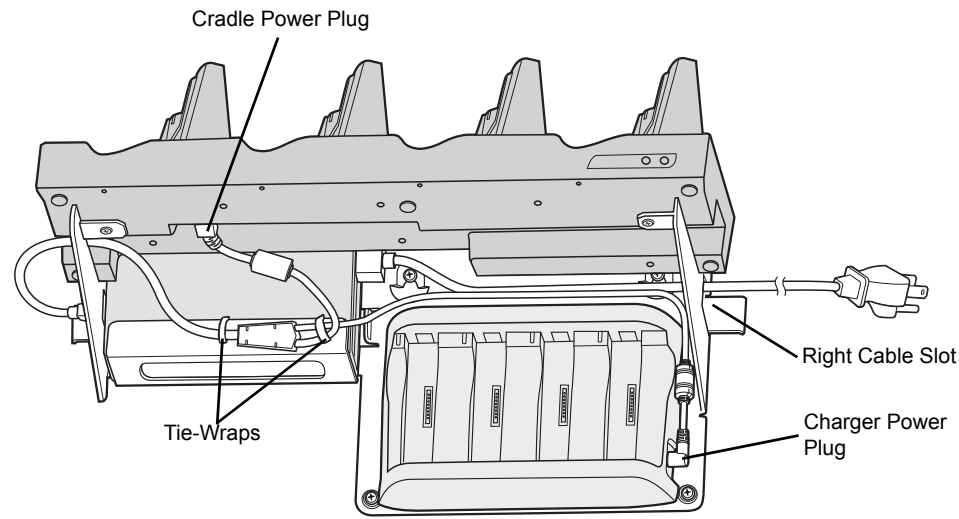

9. Use one tie-wrap to secure the AC line cord to the mounting bracket.
10. Use two tie-wraps to secure the charger power lead and the AC line cord together as shown below.

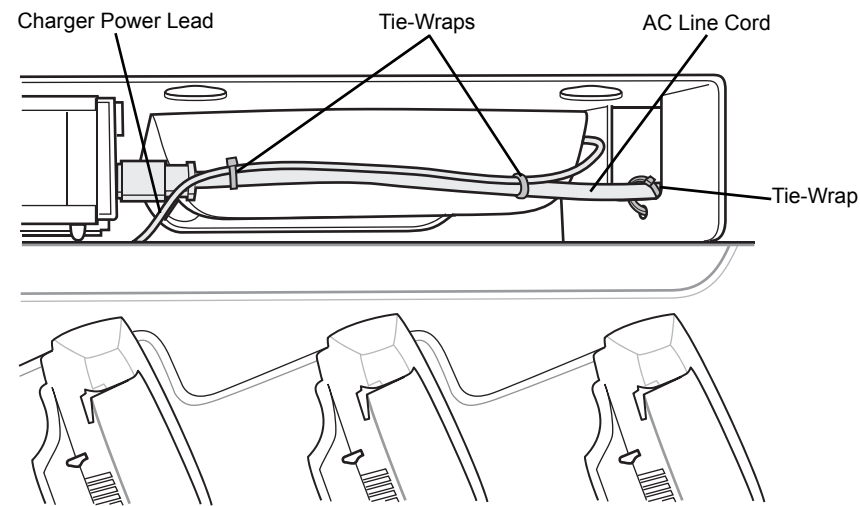

11. Plug the AC line cord into an AC power source.

Placing a Battery in the Charger

When placing a spare battery into the Four Slot Spare Battery Charger, ensure proper orientation of the battery.

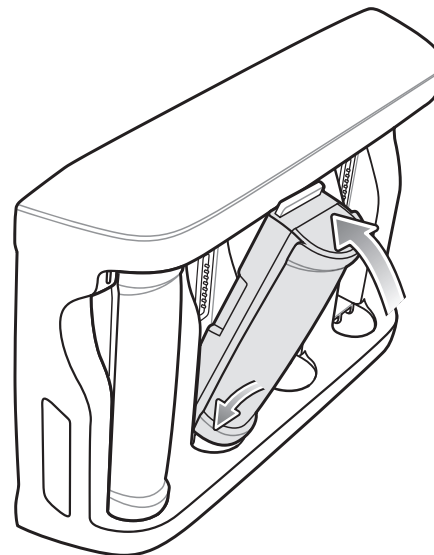

Mounting Multiple Brackets

When installing multiple brackets on a wall:

- Each mounting bracket must be 25.4 cm (10 in.) from the top of one bracket to the top of the next bracket.
- The bottom of the last bracket must be at least 61 cm (24 in.) from the floor.
- When mounting brackets next to each other the tabs must at least touch each other to ensure minimum distance between brackets.

