

M3 MOBILE

Quick Manual

Model:

SM10 (LTE)
UL10
BK10
OX10(1G)
ST10
MT10
PS10

Headquarter
4F, Namjeon Building,
44, Guujongbyeon-ro, Gwangjin-gu,
Seoul, Korea, 05116
Tel, +82 2 574 0037 (Ext.4)
Fax, +82 2 556 0155
www.m3mobile.net
sales@m3mobile.co.kr

Production Center/Service Center
Unit 610, 201
Chun-ui Techno Park, 18,
Bucheon-ro, 198beon-gil,
Wonmi-gu, Bucheon-si,
Gyeonggi-do, Korea, 14557
Tel, +82 32 623 0037
Fax, +82 70 4015 6323

Copyright©2017 M3 Mobile Co., Ltd. All Rights Reserved.

NFC

Connecting with the NFC Device

- Open a Web page or the screen of a video, photo or contact.
- Place the back part of the NFC device toward the back of the SM10(LTE)
- Touch the screen then Data transmission would be started.

Connecting to the NFC chip / Tag card

- Hold the SM10(LTE) as shown below. Do not grip antenna area of the battery cover with your hands.
- Place the SM10(LTE) near the NFC chip or tag card until the data transfer is completed. (Generally, data is displayed in the application)

CAMERA

Taking pictures

- Run the Camera program.
- Tab the Capture button to take a picture.
- Taken pictures are stored in Pictures & Video folder. (Start \Programs \Pictures&Video)

Taking videos

- Run the Camera program.
- Tab the Video Mode button to take a video.
- Taken videos are stored in Pictures&Videos folder/ (Start \Programs \Pictures&Videos)

SCANNER

Scanning

- Launching the Scanner program (either ScanEmul or M3Scan Test)
- Press the SCAN BUTTON toward barcode to read.
- Make sure the laser beam covered whole barcode to read data properly



Imaging

- Launch the Scanner program.
- Press the SCAN BUTTON toward barcode to read.
- Make sure the scanner beam covered whole barcode to read data properly.



CHARGING

LED Color	Description
Red	Battery is being charged.
Green	Battery is fully charged.

SOFT RESET

Windows :

When unexpected error occurs while using the device, SOFT RESET allows your device to restart, similar to rebooting a computer. It will adjust memory allocation - all records and entries are retained after soft reset but unsaved data or files may be lost.

- Press the RESET BUTTON briefly.

Android :

Press and hold the Power button to display the power management menu. Select the "Power Off and Restart" menu.

If the device stops its operation for a long time, press the Volume Down button + Back button + Camera button to proceed soft reset.

CLEAN BOOT

Windows :

When an unexpected error cannot be solved with SOFT RESET, perform CLEAN BOOT to restart the system. It will erase all data stored in the device except in Flash Disk and return to its default settings

Follow below steps to CLEAN BOOT. (⊞+⊞+⊞)

- Press the POWER BUTTON more than 10 seconds.
- Press and hold the (SEND) and (END) buttons together then press the POWER button briefly.
- When "Clean boot" sign will be displayed on the screen, press "1" to proceed CLEAN BOOT.

Android :

- Tap Backup & reset → Factory data reset
- Check if Erase internal SD-Card is checked →Reset Phone→Erase everything

Warning

- Risk of explosion if battery is replaced by an incorrect type. Dispose of used batteries according to the instructions.
- Battery contact pin can break if battery is forced to insert incorrectly. Watch out for the correct direction as indicated on the battery.
- Risk of explosion if unauthorized power supply is used.
- If an unapproved battery is used, it may explode.
- It may cause significant damages to your eyes if you look directly into the flash attached at camera module.

- Do not look at the laser beam directly, (Class 2 Laser product 1.0mW, Max Output : 650nm)
- If the device is used for purposes other than that described in this manual, a user may be exposed to harmful electromagnetic waves.

Caution

- Use only M3 Mobile-approved adaptor. If not, the device may malfunction or be damaged during or after its charging, or the battery performance may degrade.

SYNCHRONIZE with YOUR PC

Please download the Active Sync from Microsoft webpage to activeSync with PC.

ActiveSync :

<http://www.microsoft.com/downloads/en/details.aspx?FamilyID=9e641c34-6f7f-404d-a04b-dc0981411411>

Windows Mobile Device Center (Windows Vista and 7) :

<http://www.microsoft.com/windowsphone/en-us/howto/wp6/sync/installing-wm6c.aspx>

OS UPDATE

M3 Mobile can distribute a new OS to improve the quality and performance of a product.

The latest OS is described in the online support page of M3 Mobile. The OS can be updated through two methods :

- Use the Micro-SD Card.
- Connect the device through USB cable.
- OTA Update over Wifi (SM10(LTE))

For detailed information on OS update, please refer to the "OS"Item of the M3 FAQ (FAQ Download).

TECHNICAL SUPPORT

Should you require any services or technical support on M3 Mobile's products, contact your supplier or visit M3 Mobile technical support web page.

Technical Support Website : <http://itc.m3mobile.net>

Desired or relevant manuals can be downloaded from Manuals or FAQ in technical support webpage. User manual, especially, is included in Flash Disk so that users can obtain it from the Flash Disk as well.

For DOA or RMA, please send the defective product to suitable address after consulting the supplier.

Wireless Device Country Approvals
Europe include, Austria, Belgium, Bulgaria, Croatia, Czech Republic, Cyprus, Denmark, Estonia, Finland, France, Germany, Greece, Hungary, Iceland, Ireland, Italy, Latvia, Liechtenstein, Lithuania, Luxembourg, Malta, Netherlands, Norway, Poland, Portugal, Romania, Russia, Slovak Republic, Slovenia, Spain, Sweden, Switzerland, Turkey and the United Kingdom.

If you need more detail information, please visit M3 Mobile web site. www.m3mobile.net

SM10(LTE)

CE 2200

PACKAGE

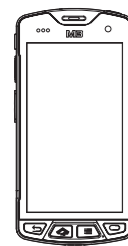

- Device
- Standard Battery
- Quick Manual

DEVICE

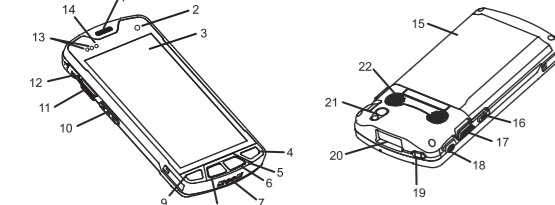

- Receiver
- Camera
- Action Button
- Microphone
- Menu Button
- Charging Contacts
- Home Button
- Back Button
- Volume Button
- Scanner Button
- Ear Jack Hole
- Power Button
- Micro-USB Connector
- Sensor
- Charging LED
- Battery Cover
- Camera Button
- Speaker
- Scanner LED
- Scanner Button
- Reset Button
- Speaker
- Speaker
- Speaker

CARD INSTALLATION

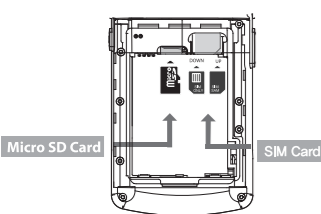

BATTERY

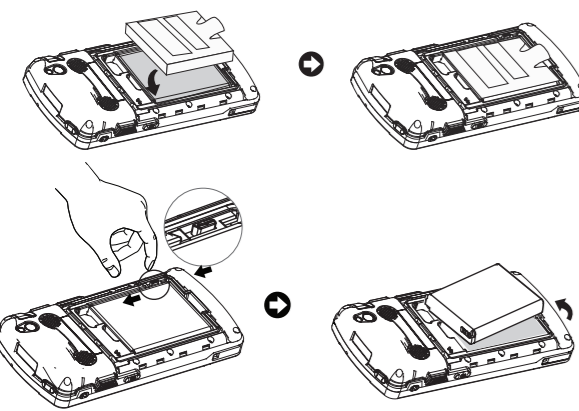

CHARGING

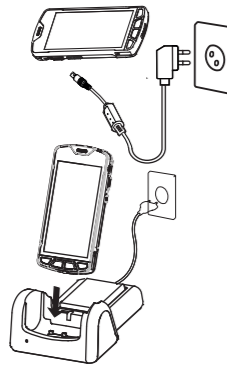

UL10

CE 0678

PACKAGE



- Device
- Standard Battery
- Stylus
- Quick Manual
- License

DEVICE

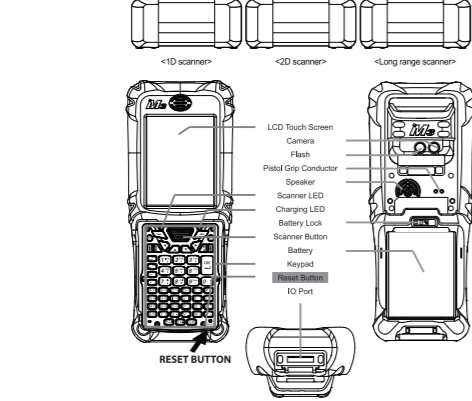

CARD INSTALLATION

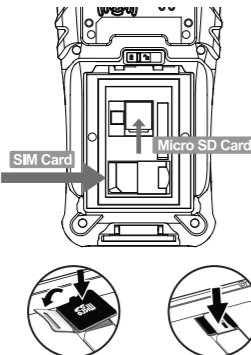

BATTERY

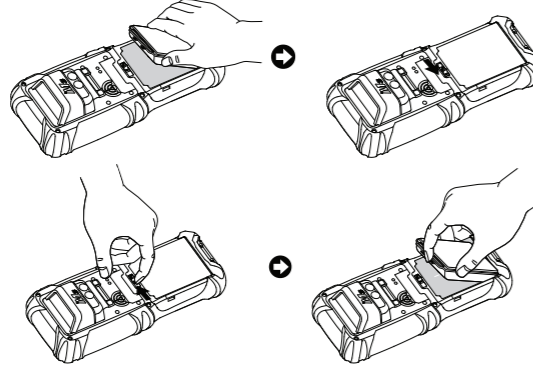

CHARGING



OX10(1G)

CE 0678

PACKAGE



- Device
- Standard Battery
- Stylus
- Quick Manual
- License

DEVICE

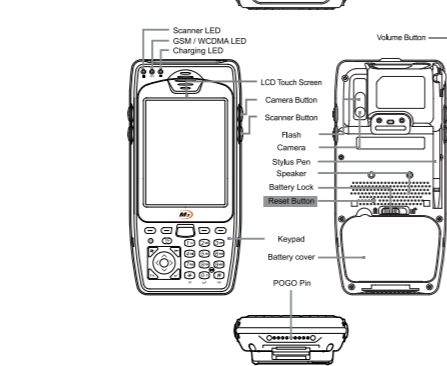

CARD INSTALLATION

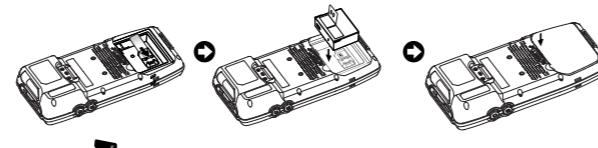

BATTERY

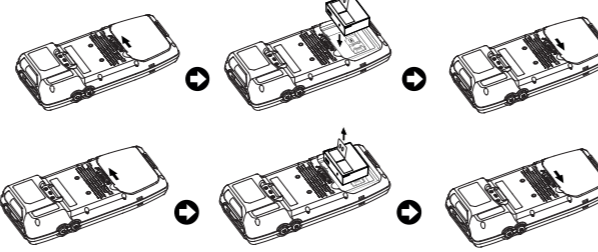

CHARGING

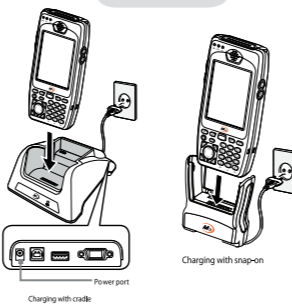

BK10

CE 0678

PACKAGE



- Device
- Standard Battery
- Stylus
- Quick Manual
- License

DEVICE

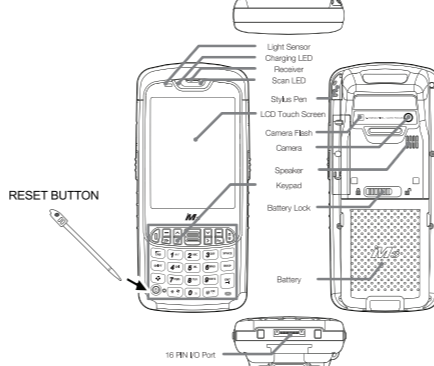

CARD INSTALLATION

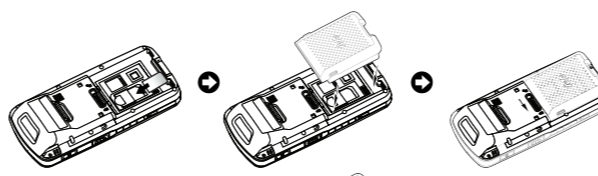

BATTERY

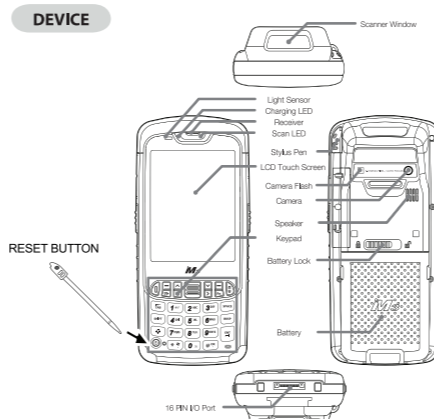
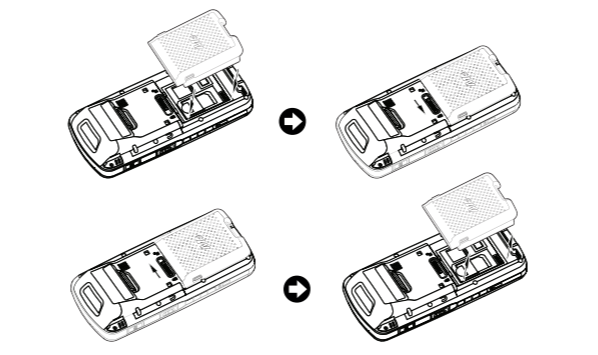

ST10

CE 0678

PACKAGE



- Device
- Standard Battery
- Stylus
- Quick Manual
- License

DEVICE

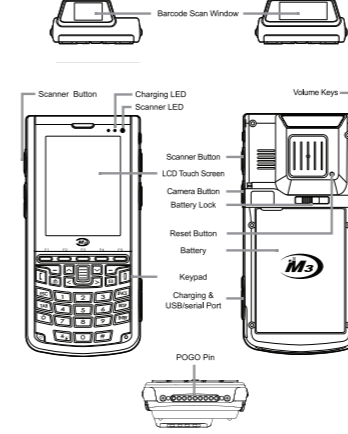

CARD INSTALLATION

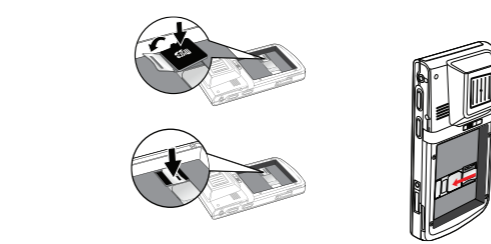

BATTERY

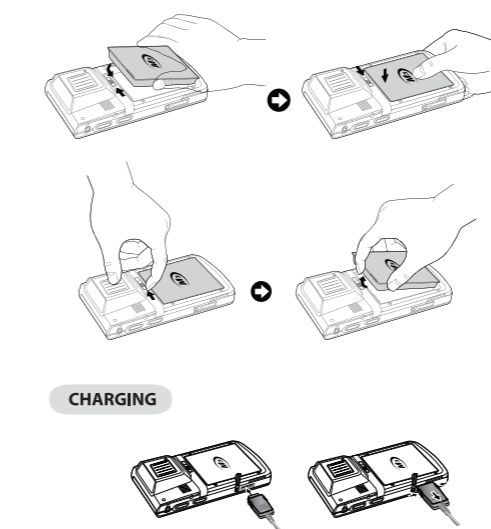

MT10

CE 0984

PACKAGE



- Device
- Standard Battery
- Stylus
- Quick Manual
- License

DEVICE

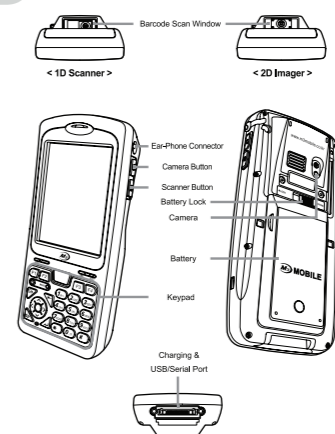

CARD INSTALLATION

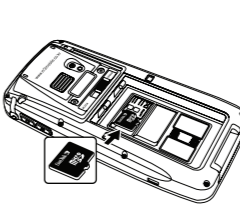

BATTERY

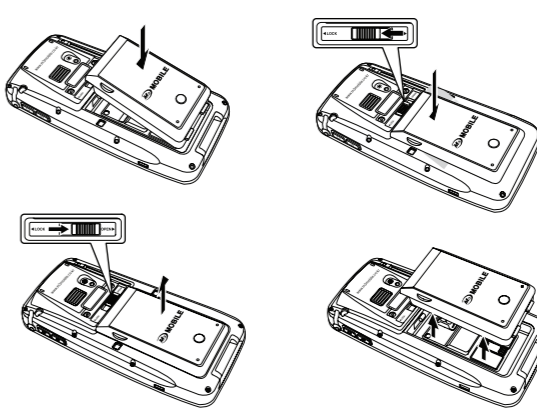

CHARGING

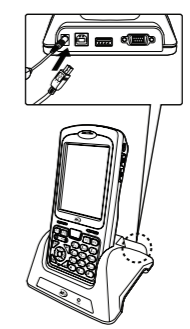

PS10

CE 0678

PACKAGE



- Device
- Standard Battery
- Stylus
- Quick Manual
- License

DEVICE

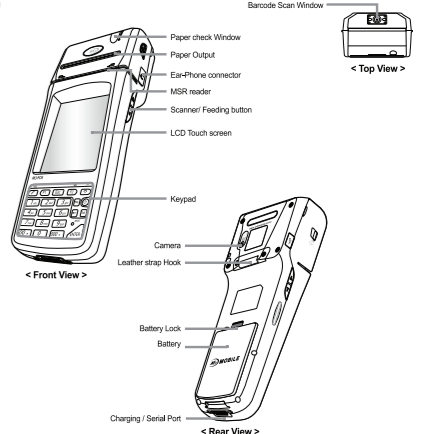

INSTALLATION

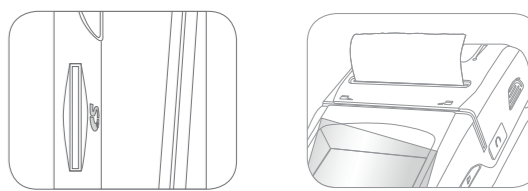

BATTERY

