

Package

Please make sure the following contents are in the EA300 gift box. If something is missing or damaged, please contact Your unitech representative.

The basic package contents

- EA300 Terminal
- Regulatory Compliance Statements
- USB Cable
- Battery
- Cradle + Cradle Adapter
- Charger Holder
- Quick Start Guide



EA300 Series Quick Guide

Battery Installation

Insert the battery into the battery compartment as shown in the picture. Battery should sit tightly in the compartment when correctly installed. Do not apply excessive force when inserting the battery.



Appearance and Buttons

Front view



To turn on: Hold power button until device switches on
 To turn off: Hold power button until the device screen shows the power off menu. Select shutdown on the menu.
 Sleep: Under operation mode, press the power button once
 Wake up: Press power button once

Side view



Rear view



Charging using cradle



Power Adaptor

P: LED indicates the cradle is operational.

C: LED should lit up to indicate charging.

1. Connect the adaptor into the cradle.

LED indicates the cradle is operational.

2. Slide the device into the cradle.

3. The device will automatically begin charging

and LED on terminal indicates the charging process.

For battery charge, please see the reference as shown

in the picture

Battery Operation

The device battery is polymer type battery, which should only be charged by using original Unitech power supply.

Metal contact is unavailable or artificial short circuit electrode.

Do not store battery in hot, humid, or corrosive environment.

Do no break or crack battery.

Do not store battery when it is fully charged completely drained.

If device is not used for long period of time, remove the battery from the device, please.

If the battery is misshapen or is found leaking, replace the battery immediately.



Installing SIM/ SD Card

1.Swing open the main battery cover clip by 90 degrees, you can then remove the battery cover.

2.Insert the SIM card or Micro SD card into theircorresponding slots in the battery compartment.

Note: You should gently push the SIM/SD card to the correct position



Connecting to PC

After you install the Android driver or an Android smart phone assistant, you can connect the devices to your PC with USB cable provide.(You can download the software mentioned above from <http://www.ute.com/>. After device connected to your PC, the screen would display like this:

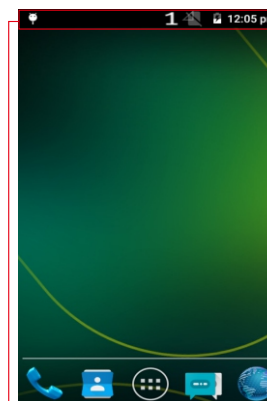

After the device connected to your PC, you could drag the top part of the screen down to show the USB options.

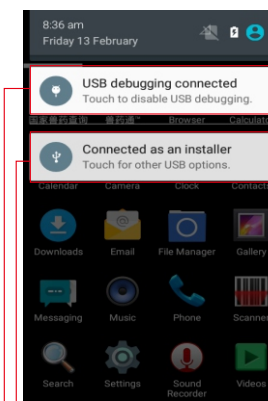

Select this option to enable / disable device as USB storage to the PC.

Select this option to enable / disable USB debugging

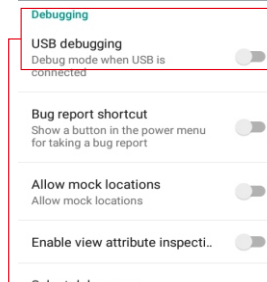
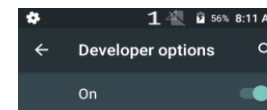

Check this to enable USB debugging.

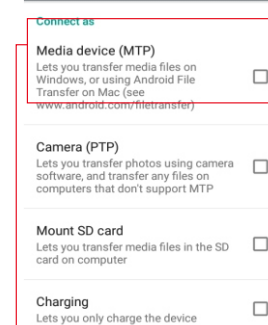
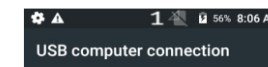

Check this to enable device as USB storage to PC.

Note: When you enable device as USB Storage to PC, the flash memory of the device are map as a PC drive. At this point of time, you cannot install APK to the device. To install APK to the device, it should not be in USB Storage mode.

CAUTION!

To ensure the unit working properly, please keep all connectors away from the contaminants staying inside of them such as dust, grease, mud, and water. The negligence may cause the unit with no communication, short circuited, overheated and so on.

If the connector is damaged, please ensure the connector is being fully repaired before using the unit to avoid causing short circuited.

<http://www.ute.com/>

Copyright 2018 unitech Electronics Co., Ltd. All rights reserved. unitech is a registered trademark of unitech Electronics Co., Ltd.

Thank you for purchasing the unitech product.

For other product documentation, please scan the QR code for more information.

